



University Hospital

MAP

Directions from University Hospital to:

Huntsman Cancer Institute and **Clinical Neurosciences Center**

Take the visitor elevators to Level 3.
Turn left out of the elevators and follow
the signs.

Moran Eye Center and **Primary Children's Medical Center**

Use hallway on Level A, adjacent to the
escalator.

Eateries

Cafeteria

Level A. Breakfast, lunch and dinner.
Hours: Mon.–Fri. 6:30 a.m.–10 p.m.,
Sat.–Sun. and holidays 8 a.m.–8 p.m.

Starbucks

Open 24 hours a day, 7 days a week.
Located on Level 1 in the lobby.

The Point Restaurant

Located on the sixth floor of the Huntsman Cancer Institute.
Open Mon.–Fri. Hours: breakfast 7 a.m.–10:30 a.m.,
lunch 11 a.m.–2 p.m.

The Bistro

Located on the sixth floor of the Huntsman Cancer Institute.
Open Mon.–Fri. 7 a.m.–9 p.m., Sat.–Sun. 11 a.m.–7 p.m.

Valet Parking

Our free valet service is available to all patients and visitors,
Mon.–Fri., 6 a.m. to 7 p.m.

Information Desk

We want you to have an excellent experience at University
Hospital. The Information Desk team provides non-clinical
services such as photocopying, faxing, phone access and
hotel accommodations for out-of-town guests. You will find
the Information Desk at the main entrance of the hospital.
Please call us anytime at (801) 587-8230.



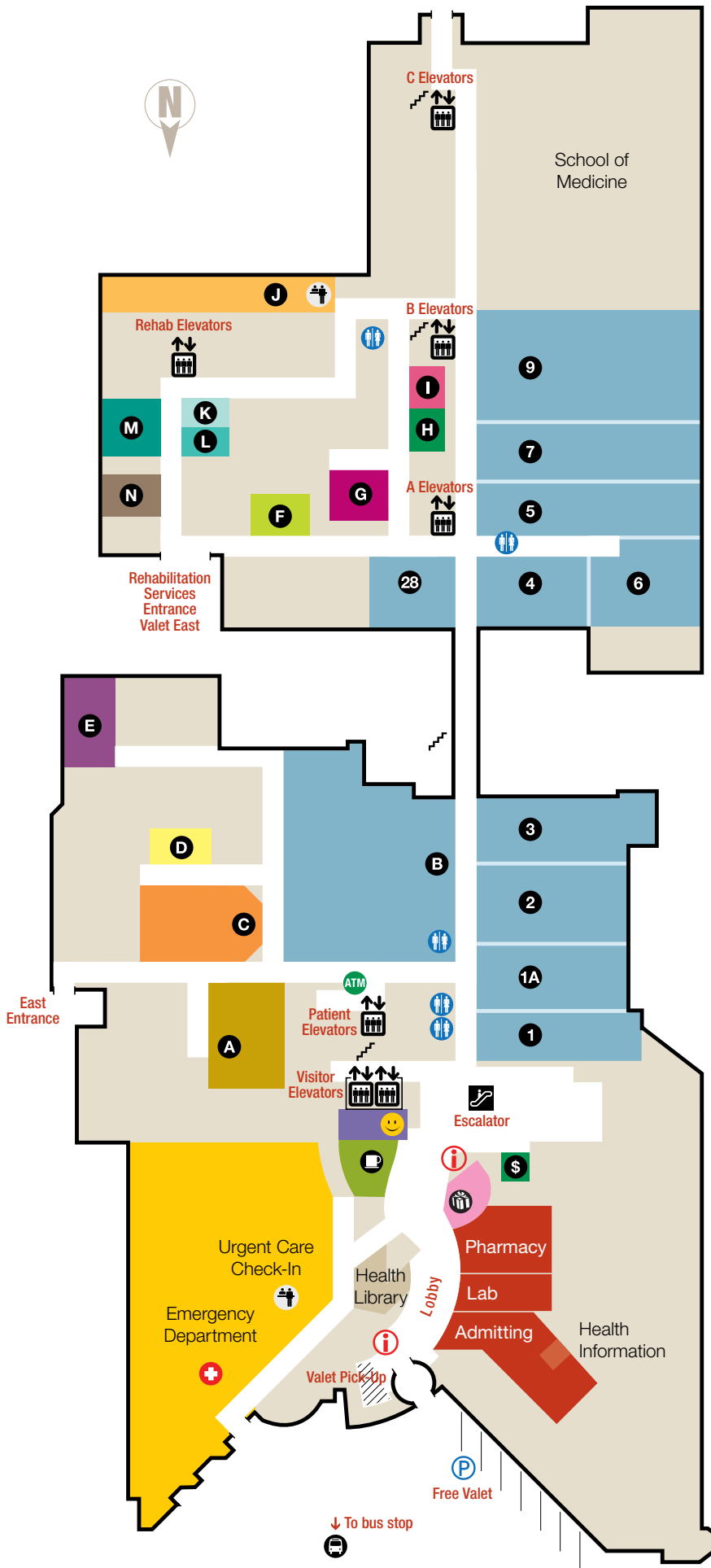

- Information
- Check-In Desk
- Elevator
- Escalator
- Stairs
- Restrooms
- ATM

Outpatient Clinics & Other Patient Services

- 1** Infusion Center/Travel Clinic
- 1A** ID Clinic (Infectious Diseases)
- 2** Internal Medicine Clinic
- 2** Rheumatology Clinic
- 3** Pulmonary Clinic
- 3** Gastroenterology Clinic
- 4** OB/GYN Clinic
- 5** Surgery Clinic
- 6** Pediatrics Clinic
- 7** Dental Clinic
- 9** ENT/Audiology Clinic
- 9** Hearing Aid Services
- 28** Dermatology Clinic
- A** Emergency Care Unit
- B** Cardiovascular Center
- C** Radiology (X-Ray)
- D** Radiology File Room
- E** MRI/Nuclear Medicine
- F** Thrombosis Center
- G** Interventional Radiology
- H** Medical Dermatology
- H** Mohs Surgery
- I** Rehabilitation Psychology
- J** Physical Medicine & Rehab/Wound Clinic
- K** OT Gym
- L** PT Gym
- M** PT Exercise Gym
- N** Wound Clinic
- \$** Cashier
- Customer Service
- Emergency Department
- Gift Shop
- Starbucks
- Level A** Cafeteria (see map on reverse)
- Level A** Health Information (see map on reverse)
- Level A** Kidney & Liver Clinic (see map on reverse)

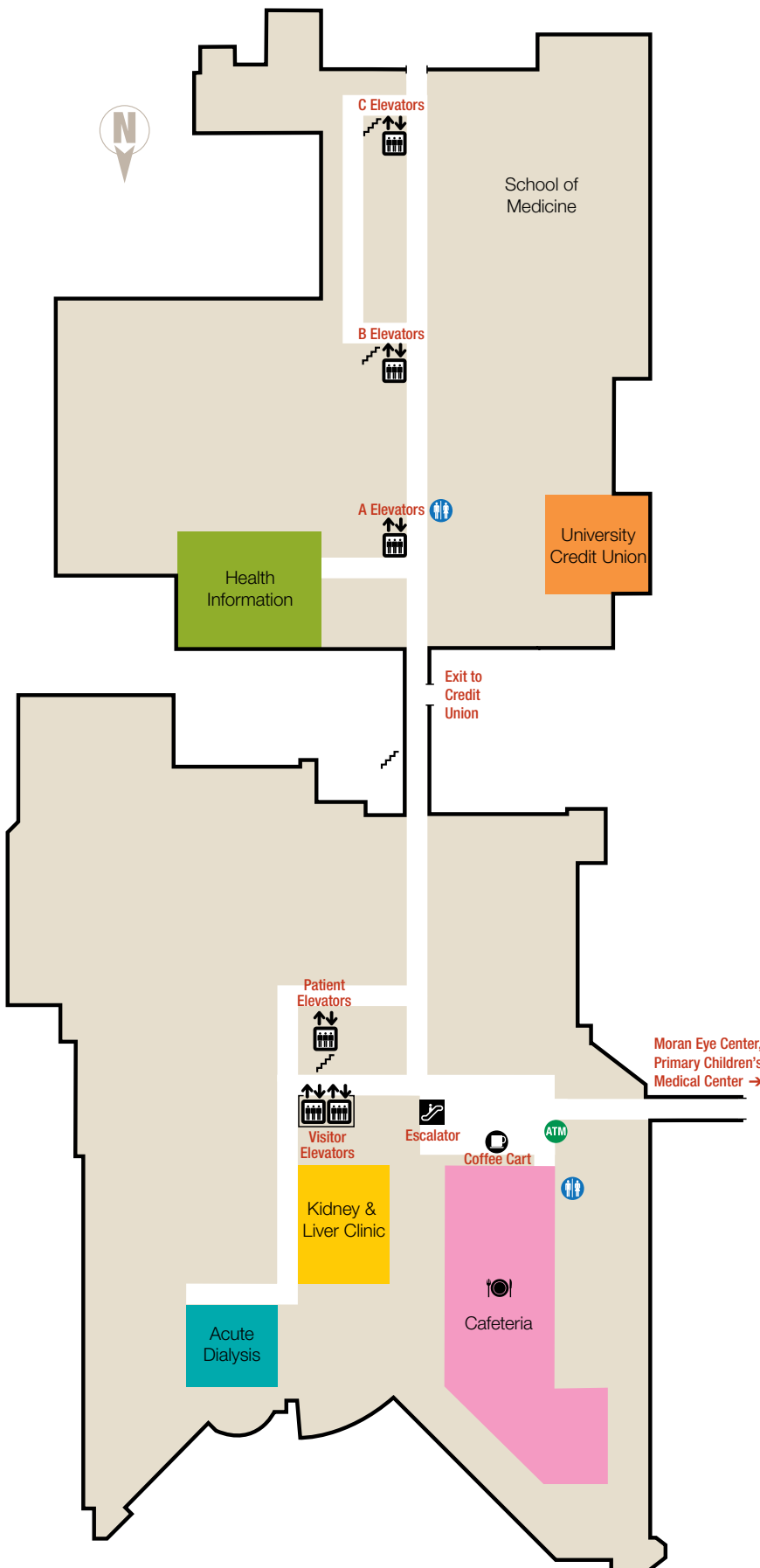

- 5 West (Level 5)
- Acute Dialysis (Level A)
- Acute Internal Medicine–A (Level 5)
- Acute Internal Medicine–B (Level 4)
- Burn Center (Level 4)
- Burn Outpatient Clinic (Level 4)
- Cardiac Prep and Recovery (Level 4)
- Cardiac Rehab (Level 5)
- Cardiovascular Intensive Care Unit (Level 2)
- Cath Lab/Heart Monitor (Level 4)
- CCTS Dexa Scan (Level 3)
- Cardiovascular Medical Unit (Level 4)
- Clinical Library (Level 4)
- Clinical Neurosciences Center (Level 3)
- Discharge Lounge (Level 3)
- EEG Lab (Level 3)
- Endoscopy (Level B)
- EP MRI Lab (Level 4)
- Hope Chapel (Level 2)
- Huntsman Cancer Institute (Level 3)
- Inpatient Medical Rehab (Level 2)
- Labor & Delivery (Level 2)
- Maternal Fetal Diagnostic Center (Level 2)
- Maternal Newborn Care (Level 2)
- Medical ICU/CCU (Level 4)
- Moran Eye Center (Level A)
- Neuro Acute Care (Level 3)
- Neuro Critical Care (Level 3)
- Newborn ICU (Level 2)
- Nursery (Level 2)
- OB Emergency Services (Level 2)
- OB Special Care (Level 2)
- OR 20 Procedure Area (Level 3)
- Ortho Trauma & Surgical Specialty (Level 6)
- Orthopedic Physical Therapy (Level 6)
- Patient Rooms
 - 2000–2999 (Level 2)
 - 3000–3999 (Level 3)
 - 4000–4999 (Level 4)
 - 5000–5999 (Level 5)
 - 6000–6999 (Level 6)
- Pelvic Care Center (Level 3)
- Perinatal Genetics (Level 2)
- Primary Children’s Medical Center (Level A)
- Pulmonary Lab (Level B)
- Respiratory Therapy (Level 2)
- Surgery (Level 3)
- Surgical Intensive Care (Level 2)
- Surgical Specialty & Transplant (Level 5)
- Urology (Level 3)
- West Pavillion 5 (Level 5)
- Women’s Special Care (Level 2)
- Wound, Ostomy Nurse Specialists (Level 6)

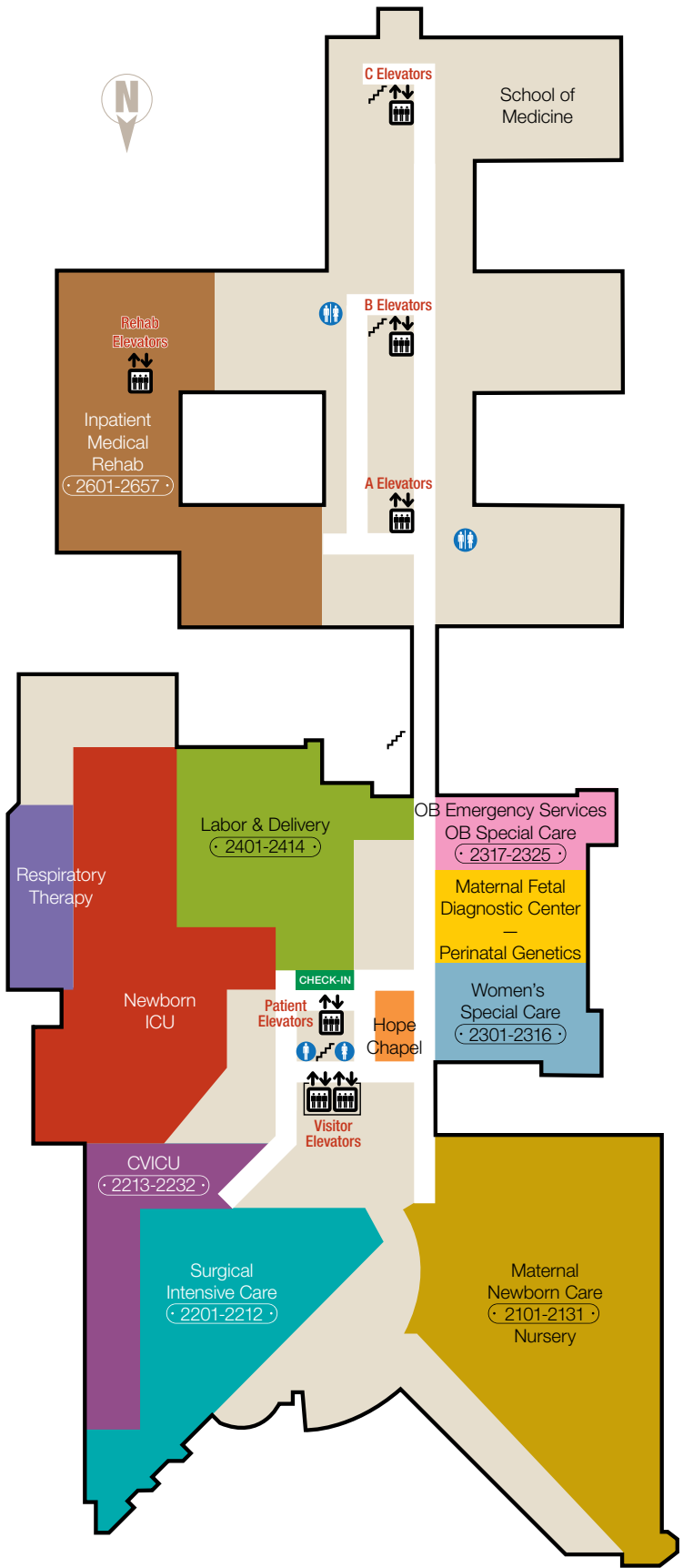

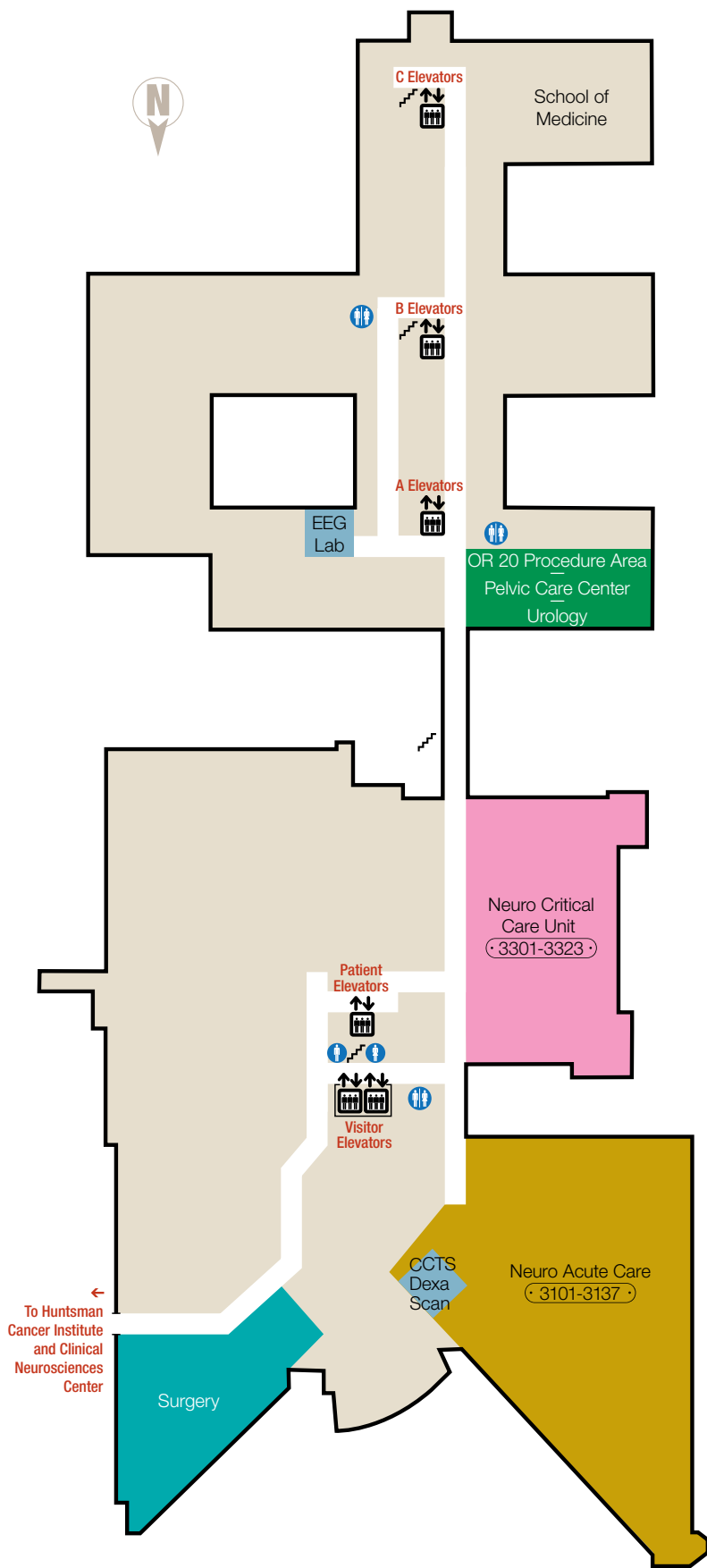

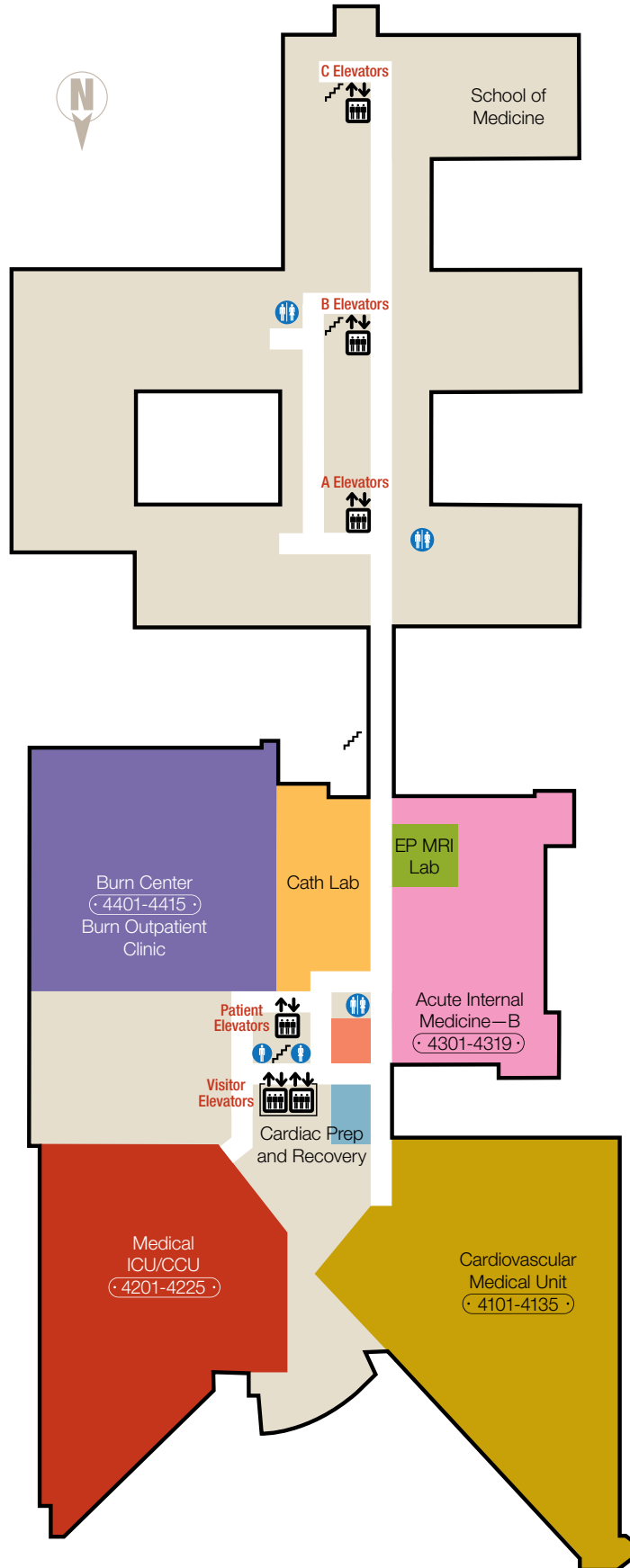

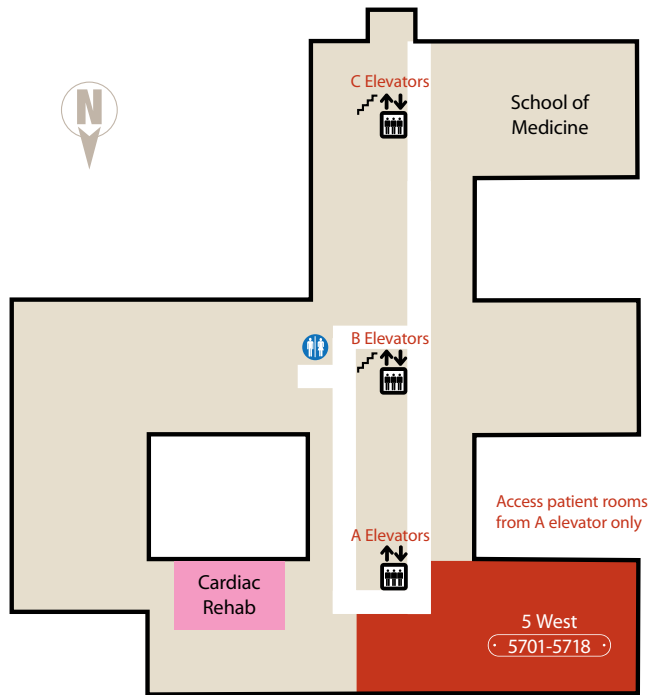

BUILDINGS ARE NOT CONNECTED

